

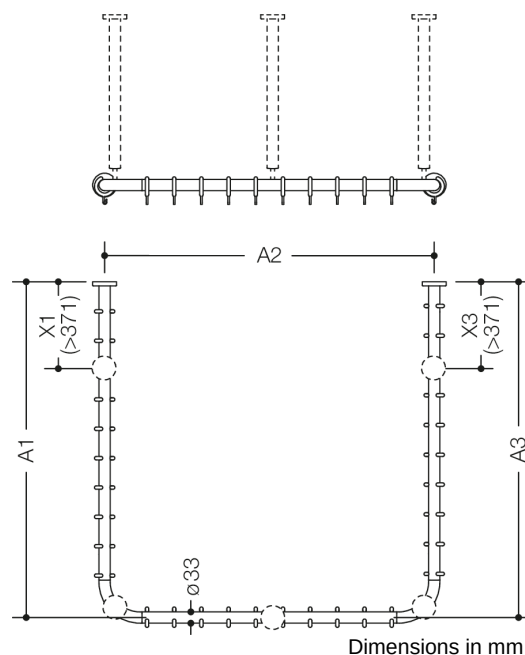

Similar picture



Properties





Range 801 shower curtain rail, with additional preparation for ceiling suspension on the legs

- horizontally arranged rails connected at right-angles in U-shape, with curtain rings
- used to hang a shower curtain
- with metal core
- fixing onto wall and ceiling with roses, ceiling supports required
- with an appropriate number of curtain rings
- leg lengths A1/A2/A3 made-to-measure, A1/A3 from 220 mm to 3383 mm, A2 from 320 mm to 3367 mm
- bar diameter 33 mm, rose diameter 70 mm
- with preparation for ceiling suspension in the bend and additionally on one or three legs A1/A2/A3
- a leg length A1/A2/A3 1984 mm always requires an additional ceiling suspension on the legs, this is optional up to a length of 1983 mm
- The position of the preparation for ceiling suspension X1/X3 on the legs A1/A3 is freely selectable. The distance between the wall and preparation of the ceiling suspension X1/X3 is at least 371 mm. The distance to the connecting bend must be at least 211 mm.
- The preparation of the ceiling suspension on leg A2 is centrally positioned
- made of high-quality matt polyamide in HEWI colours 99 (pure white), 98 (signal white), 97 (light grey), 95 (stone grey) and 92 (anthracite grey)

Awards

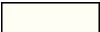

Colours / Surfaces

	99 (pure white)
	98 (signal white)
	97 (light grey)
	95 (stone grey)

	92 (anthracite grey)
---	----------------------