

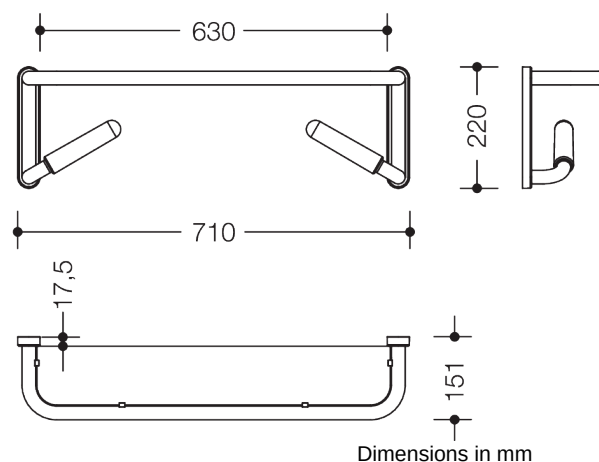

Similar picture



Properties

Range 802 LifeSystem Mirror shelf

- chrome-plated mirror shelf with all-round edging and firmly fitted, break proof synthetic material shelf
- with integrated support rails
- used for support, for standing up independently and for holding accessories
- continuous mirror solution possible
- 710 mm wide, 220 mm high, 151 mm deep
- 30° position of the support rails on delivery, adjustable on site
- shelf surface in opaque white synthetic material
- frame made of highly polished chrome-plated aluminium with powder coated, matt design features
- handles made of pleasant to touch polyamide selected HEWI colours
- produced in accordance with CE- and UKCA-Regulation (EU) 2017/745 on medical devices
- including non-corrosive HEWI fixing material

Awards



reddot design award
winner 2003

Colours / Surfaces

	99 (pure white)		92 (anthracite grey)		74 (apple green)		36 (coral)
	98 (signal white)		90 (jet black)		72 (may green)		33 (ruby red)
	97 (light grey)		86 (sand)		55 (aqua blue)		24 (orange)
	95 (stone grey)		84 (umber)		50 (steel blue)		18 (mustard yellow)