

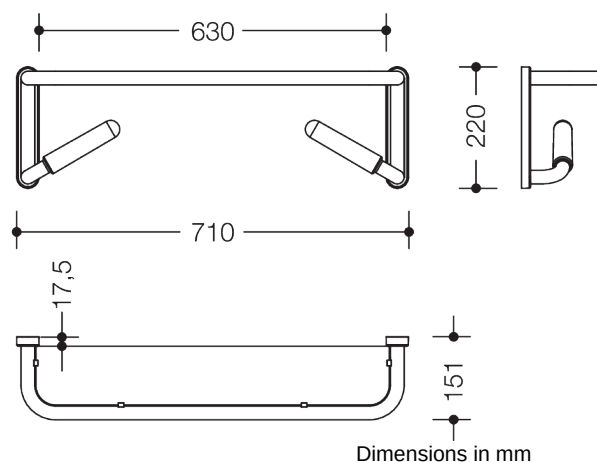

Similar picture



Properties

Range 802 LifeSystem White Edition Mirror shelf

- chrome-plated mirror shelf with all-round edging and firmly fitted, break proof synthetic material shelf
- with integrated support rails
- used for support, for standing up independently and for holding accessories
- continuous mirror solution possible
- 710 mm wide, 220 mm high, 151 mm deep
- 30° position of the support rails on delivery, adjustable on site
- shelf surface in opaque white synthetic material
- frame made of highly polished chrome-plated aluminium with powder coated, white design features
- handles made of pleasant to touch polyamide in HEWI colours 98 (signal white) and 99 (pure white)
- produced in accordance with CE- and UKCA-Regulation (EU) 2017/745 on medical devices
- including non-corrosive HEWI fixing material

Awards



Certificates



Colours / Surfaces

	99 (pure white)
	98 (signal white)