

Similar picture

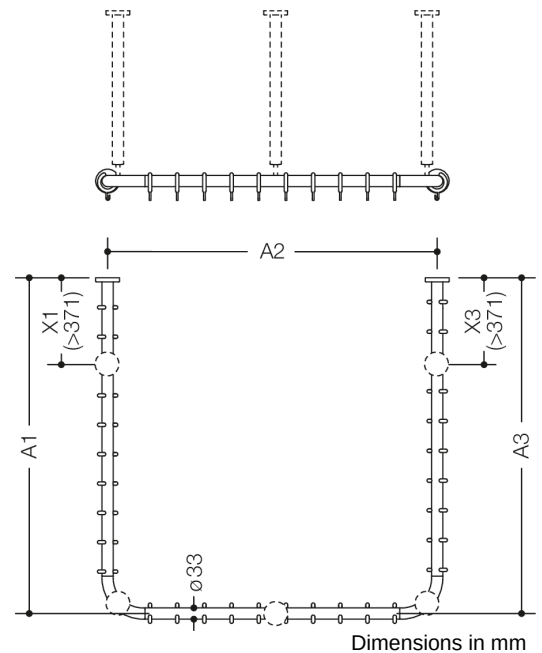

## Properties

Range 801 shower curtain rail, with additional preparation for ceiling suspension on the legs

- horizontally arranged rails connected at right-angles in U-shape, with curtain rings
- used to hang a shower curtain
- with metal core
- fixing onto wall and ceiling with roses, ceiling supports required
- with an appropriate number of curtain rings
- leg lengths A1/A2/A3 made-to-measure, A1/A3 from 220 mm to 3383 mm, A2 from 320 mm to 3367 mm
- bar diameter 33 mm, rose diameter 70 mm
- with preparation for ceiling suspension in the bend and additionally on one or three legs A1/A2/A3
- a leg length A1/A2/A3 1984 mm always requires an additional ceiling suspension on the legs, this is optional up to a length of 1983 mm
- The position of the preparation for ceiling suspension X1/X3 on the legs A1/A3 is freely selectable. The distance between the wall and preparation of the ceiling suspension X1/X3 is at least 371 mm. The distance to the connecting bend must be at least 211 mm.
- The preparation of the ceiling suspension on leg A2 is centrally positioned
- made of high-quality polyamide according to HEWI colour chart

## Awards



## Colours / Surfaces

	99 (pure white)
	98 (signal white)
	97 (light grey)
	95 (stone grey)

	92 (anthracite grey)
	90 (jet black)
	86 (sand)
	84 (umber)

	55 (aqua blue)
	50 (steel blue)
	33 (ruby red)
	18 (mustard yellow)