

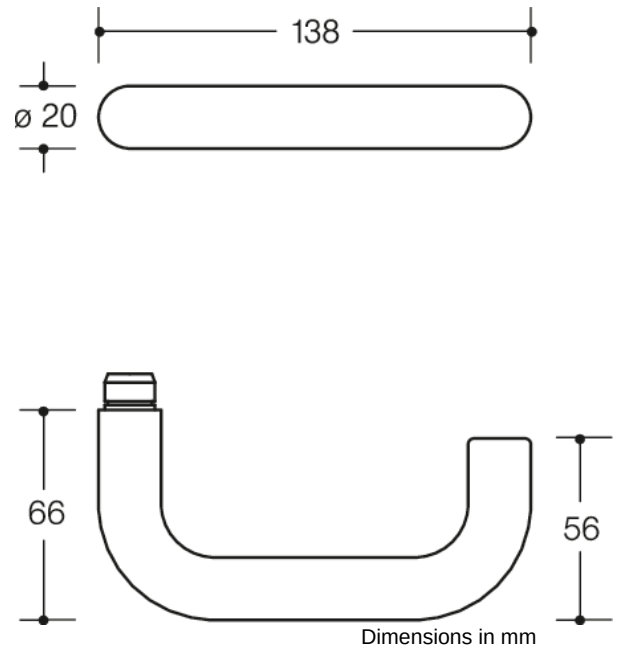

Similar picture



### Properties

Vacant/Engaged fitting

in R-technology with roses according to DIN 18255 and EN 1906 made of polyamide, high-polished surface, consisting of:

Lever handle model 111R U-shaped made of high-quality polyamide with corrosion resistant steel insert, solid colour, diameter 20 mm, with stepped shoulder guide and groove, easily installed by latching the lever handle into the base parts pre-mounted on the door.

The latching can be released using the dismantling tool. The lever handle meets the standards of EN 179 and DIN 18040.

Roses: model 305.20... and 306.23NR roses substructure made of synthetic material-stainless steel composite, can be used for left and right-hand opening doors. Fixed rotating bearing of the lever handle with automatically latching all-round locking and 5 mm journal as maintenance-free plain bearing with elastic compensating area and second journal in the neck of the lever handle. Concealed, non-loosening screwed joint with M4 screw and sleeve combination as well as the pivot disappearing into the door leaf. WC version with emergency opening by means of square spindle or coin and occupancy disc (red/white indicator) on the outside.

Rose cap, round, made of high-quality polyamide, solid colour, diameter 55 mm, 10.5 mm high, flat, 1.5 mm wall thickness.

Designed and tested for the projects segment, user category to EN 1906 - Class 4 fitting with spindle 8 - 8.5 mm user category: Class 4

Durability: Class 7

Door weight: No classification specified

Fire resistance: Class 0

Safety: Class 1

Corrosion resistance: Class 5

Burglary protection: Class 0

Design-type: U

Sustainability: EPD Environmental Product Declaration









## Awards

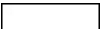

## Certificates



## Colours / Surfaces

	99 (pure white)		92 (anthracite grey)		18 (mustard yellow)
	98 (signal white)		90 (jet black)		
	97 (light grey)		50 (steel blue)		
	95 (stone grey)		33 (ruby red)		