

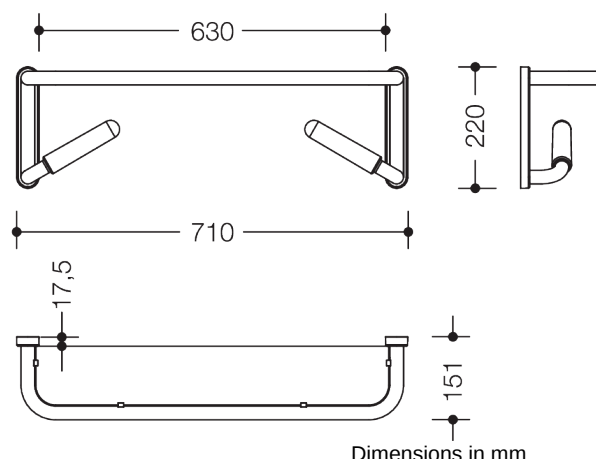

Similar picture



Properties

Range 802 LifeSystem Mirror shelf

- chrome-plated mirror shelf with all-round edging and firmly fitted, break proof synthetic material shelf
- with integrated support rails
- used for support, for standing up independently and for holding accessories
- continuous mirror solution possible
- 710 mm wide, 220 mm high, 151 mm deep
- 30° position of the support rails on delivery, adjustable on site
- shelf surface in opaque white synthetic material
- frame made of highly polished chrome-plated aluminium with powder coated, matt design features
- handles made of pleasant to touch polyamide selected HEWI colours
- produced in accordance with CE- and UKCA-Regulation (EU) 2017/745 on medical devices
- including non-corrosive HEWI fixing material

Awards



Certificates



Colours / Surfaces

 18 (mustard yellow)	 50 (steel blue)	 86 (sand)	 97 (light grey)
 24 (orange)	 55 (aqua blue)	 90 (jet black)	 98 (signal white)
 33 (ruby red)	 74 (apple green)	 92 (anthracite grey)	 99 (pure white)
 36 (coral)	 84 (umber)	 95 (stone grey)	 72 (may green)